

PLAN

NOTE
FOOTINGS ARE TO BE DESIGNED BY
A QUALIFIED STRUCTURAL
ENGINEER AND SUBMITTED TO
COUNCIL FOR EVALUATION AND
APPROVAL.

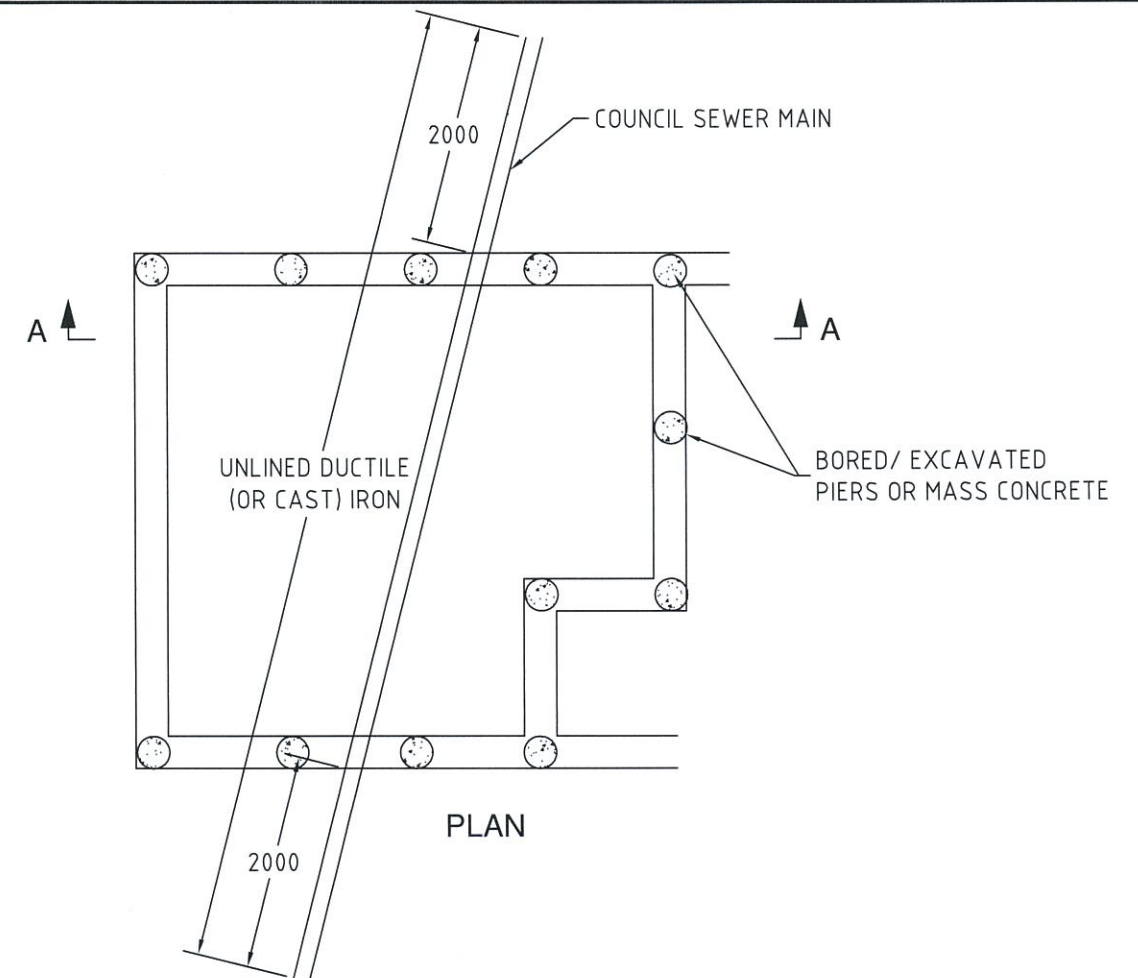

PLAN

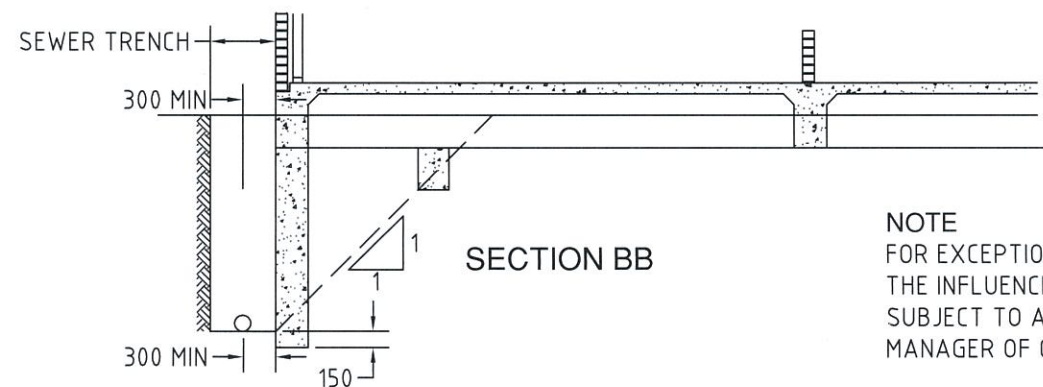

SECTION BB

NOTE
FOR EXCEPTIONAL GROUND CONDITIONS
THE INFLUENCE LINE MAY BE VARIED
SUBJECT TO APPROVAL BY THE
MANAGER OF CITY SERVICES.

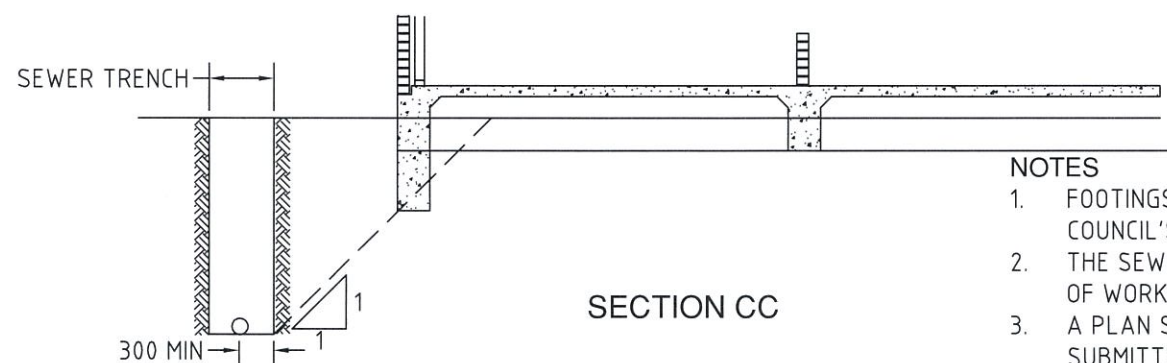

SECTION CC

NOTES

1. FOOTINGS ARE TO BE DESIGNED SUCH THAT NO WEIGHT IS TO BE EXERTED ON COUNCIL'S SEWER MAIN.
2. THE SEWER MAIN IS TO BE ACCURATELY LOCATED PRIOR TO THE COMMENCEMENT OF WORK.
3. A PLAN SHOWING THE DESIGN FOOTINGS AND SEWER LOCATION IS TO BE SUBMITTED TO COUNCIL FOR APPROVAL.

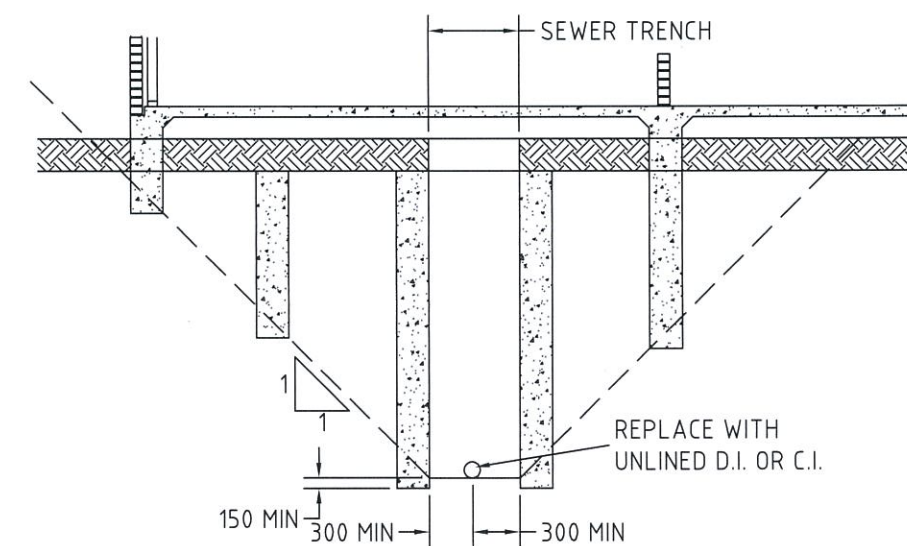

SECTION AA

APPROVED 6 / 7 / 11

GROUP LEADER - SERVICES

FOOTINGS IN THE VICINITY
OF SEWER MAINS

SCALE NOT TO SCALE

REV. A3

DRAWING NUMBER
STD-S-50

DATE	AMENDMENTS	INT.
REVISIONS		